

GRADING NOTES:

1. CONTRACTOR SHALL SAWCUT EXISTING PAVEMENT AS NECESSARY TO ASSURE A SMOOTH FIT AND CONTINUOUS GRADE. CONTRACTOR TO LIBERALLY APPLY TACK COAT AT INTERFACE OF EXISTING AND NEW PAVEMENT.
2. CONTRACTOR SHALL VERIFY HORIZONTAL AND VERTICAL LOCATION OF ALL EXISTING STORM SEWER STRUCTURES, PIPES, AND UTILITIES PRIOR TO CONSTRUCTION.
3. CLEARING AND GRUBBING LIMITS SHALL INCLUDE ALL AREAS DISTURBED BY GRADING OPERATIONS.
4. ALL CONSTRUCTION SHOWN SHALL BE PERFORMED IN ACCORDANCE WITH PLANS AND SITE SPECIFICATIONS FOR THIS PROJECT AND SHALL BE IN ACCORDANCE WITH CONSTRUCTION ACTIVITIES BASED ON PLANS AND SPECIFICATIONS WHICH HAVE BEEN PROPERLY ISSUED FOR CONSTRUCTION PURPOSES.
5. CONTRACTOR SHALL REFER TO ARCHITECT'S PLANS FOR ACTUAL BUILDING DIMENSIONS, TRUCK DOCK INFORMATION, SIDEWALK LAYOUT AND DETAILS, STEPS, RAMPS, ETC.
6. THE CONTRACTOR SHALL CONFORM AND COMPLY WITH REQUIREMENTS DEFINED IN AN EXPLORATION AND GEOTECHNICAL ENGINEERING EVALUATION PREPARED BY GMS TESTING, INC. DATED APRIL 12, 1999 FOR SITE PREPARATION, EXCAVATION, FILLING COMPACTION AND TESTING. THE CONTRACTOR SHALL EVALUATE THIS INFORMATION PRIOR TO BEGINNING ANY GRADING OR CONSTRUCTION OPERATIONS.
7. ANY GRADED OR DISTURBED AREAS SHALL HAVE 4 INCHES OF TOPSOIL WITH SEED, MULCH, FERTILIZER, AND WATER APPLIED UNTIL A HEALTHY STAND OF GRASS IS OBTAINED.

GENERAL NOTES:

1. ALL EXISTING AND REQUIRED COUNTY RIGHT OF WAYS AND EASEMENTS ARE SHOWN ON THE CONSTRUCTION PLANS. STRUCTURES SUCH AS WALLS, SIGNS, FENCES, BUILDINGS, ETC. OR PLANTS SUCH AS TREES OR SHRUBS SHALL NOT BE PLACED IN THE RIGHT OF WAYS OR EASEMENTS WITHOUT PROPER APPROVAL FROM FRANKLIN COUNTY.
2. OTHER THAN SHOWN ON APPROVED PLANS GRADING OPERATIONS INVOLVING CUTTING OR FILLING SHALL NOT BE ALLOWED WITHIN FRANKLIN COUNTY RIGHT OF WAYS AND EASEMENTS.

EROSION AND SEDIMENT CONTROL NOTES:

1. THE CONTRACTOR SHALL PREVENT THE ESCAPE OF SEDIMENT FROM THE SITE BY INSTALLING EROSION CONTROL MEASURES AND PRACTICES PRIOR TO, OR CONCURRENT WITH LAND DISTURBING ACTIVITIES.
2. EROSION CONTROL MEASURES SHALL BE MAINTAINED AT ALL TIMES. IF FULL IMPLEMENTATION OF THE APPROVED PLANS DOES NOT PROVIDE SUFFICIENT EROSION AND SEDIMENT CONTROL, ADDITIONAL CONTROL MEASURES SHALL BE IMPLEMENTED. CONTRACTOR IS RESPONSIBLE FOR REPAIRING OR REPLACING EROSION CONTROL DEVICES WHICH BECOME INEFFECTIVE.
3. ALL EROSION CONTROL MEASURES SHALL MEET THE GUIDELINES SET FORTH IN THE "ALABAMA HANDBOOK OF EROSION CONTROL", AND COUNTY AND LOCAL EROSION AND SEDIMENT CONTROL GUIDELINES AS A MINIMUM STANDARD.
4. CONTRACTOR SHALL OBTAIN ALL NECESSARY PERMITS FOR ALL GRADING AND OTHER LAND DISTURBING ACTIVITIES PRIOR TO BEGINNING CONSTRUCTION.
5. THE CONTRACTOR IS RESPONSIBLE FOR THE CLEANUP AND REMOVAL OF ANY BUILDUP OF SEDIMENT WHICH ESCAPES FROM THE SITE.
6. THE CONTRACTOR IS RESPONSIBLE FOR REMOVING SILT FROM THE SITE (IF NOT REUSABLE ON SITE) AND FOR CORRECTING HORIZONTAL AND VERTICAL ALIGNMENT OF DITCHES, IF NECESSARY AT THE COMPLETION OF CONSTRUCTION.
7. CONTRACTOR IS RESPONSIBLE FOR CLEANING SILT AND DEBRIS OUT OF ALL STORM DRAINAGE STRUCTURES UPON THE COMPLETION OF CONSTRUCTION.
8. THE CONTRACTOR IS RESPONSIBLE FOR REMOVING ALL TEMPORARY EROSION CONTROL MEASURES AFTER CONSTRUCTION IS COMPLETE AND ALL DISTURBED AREAS HAVE BEEN STABILIZED.
9. THE CONTRACTOR IS RESPONSIBLE FOR ALL COSTS ASSOCIATED WITH ANY FINES LEVIED AGAINST THE SITE FOR VIOLATIONS OF EROSION CONTROL REGULATIONS.
10. THE CONTRACTOR IS RESPONSIBLE FOR THE PROPER HANDLING AND STORAGE OF HAZARDOUS MATERIALS SUCH AS: PAINTS, FUELS, FERTILIZERS, POISONS, ETC. DURING CONSTRUCTION. APPROPRIATE SPILL PREVENTION SHOULD BE IMPLEMENTED TO REDUCE THE POSSIBILITY OF CONTAMINATING STORMWATER RUNOFF.
11. CONTRACTOR SHALL PROVIDE TEMPORARY GROUND COVER FOR ALL AREAS WITH EXPOSED SOIL WHICH WILL NOT BE DISTURBED BY GRADING OPERATIONS FOR A PERIOD OF FOURTEEN (14) DAYS OR MORE.

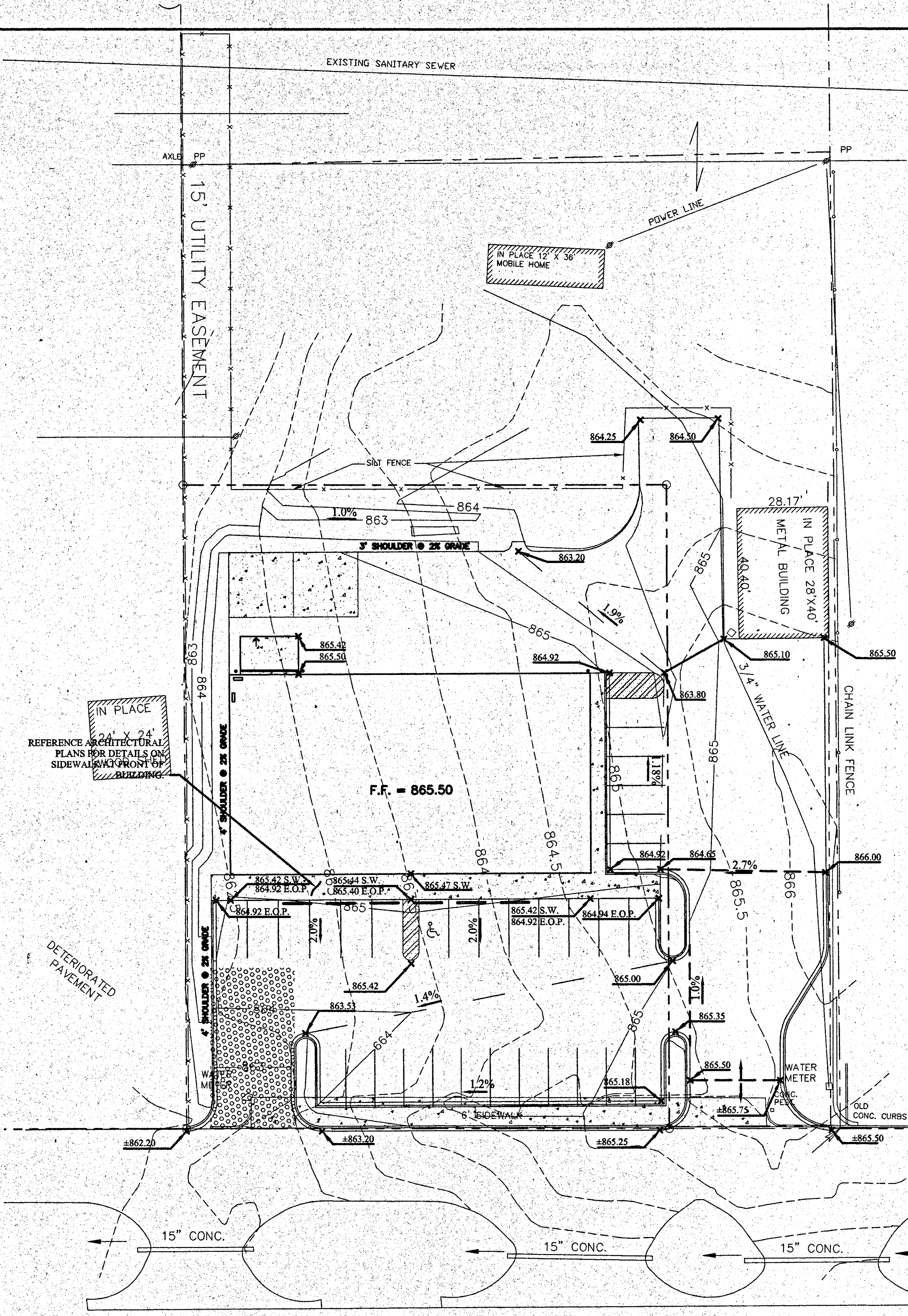

MH
FL. EL. 856.39

LEGEND

| | |
|---------------------|---------|
| MAJOR 2' CONTOURS | — 000 — |
| MINOR 0.5' CONTOURS | — 000 — |
| HIGH-POINT LINE | — — — — |
| STORM PIPE | — S — |
| SILT FENCE | — X — |
| WATER MAIN | — W — |
| OVERHEAD ELECTRIC | — OH — |
| SANITARY SEWER | — S — |

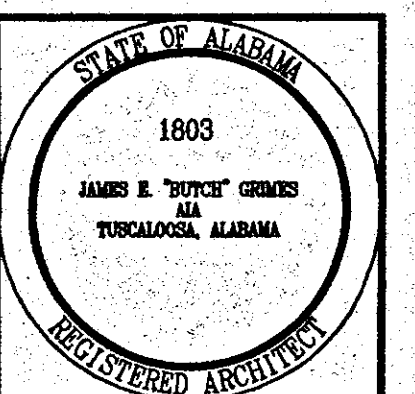

GRIMES + ARCHITECTS
ARCHITECTURE / PLANNING / INTERIORS
James E. Grimes / 905 21st Avenue / Tuscaloosa / AL 35401

**CARPORT
DISCOUNT AUTO
PARTS STORE**

SITE PLAN

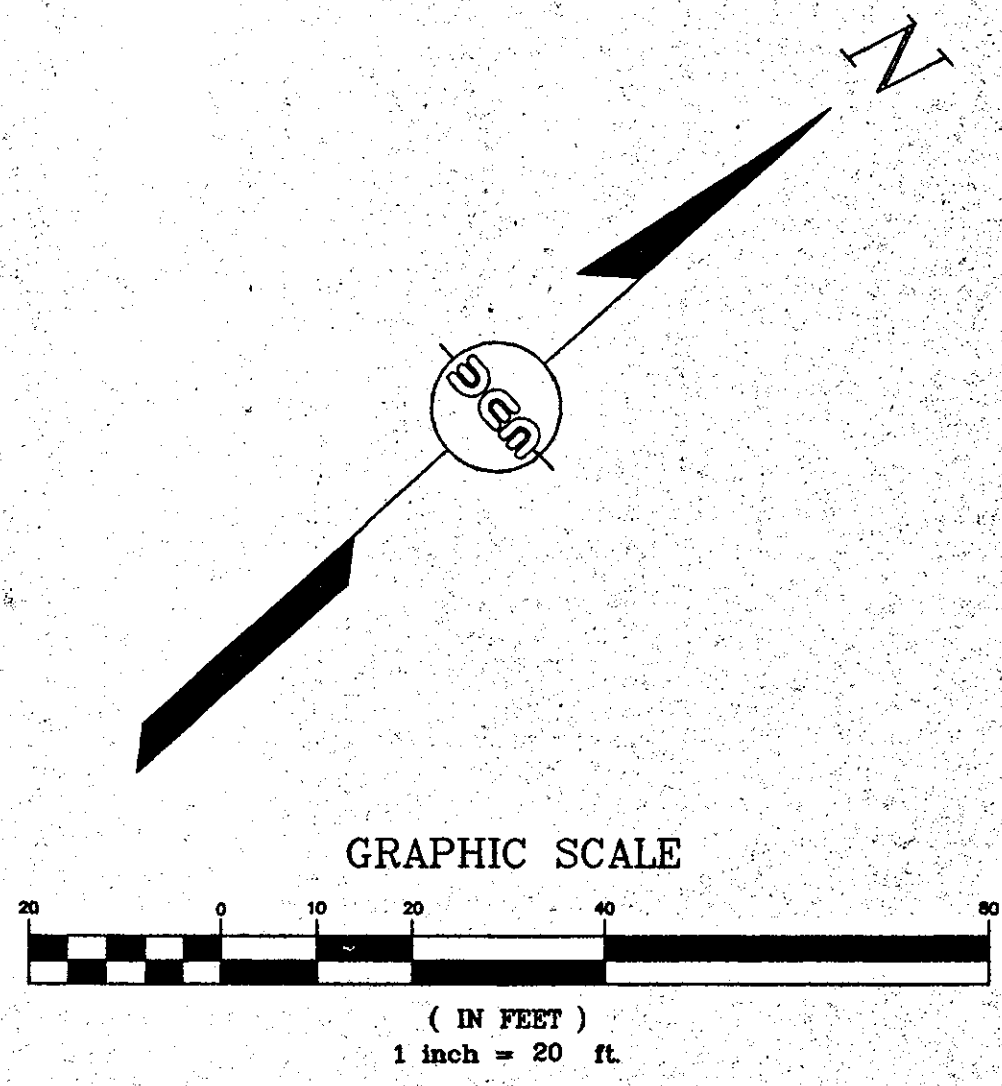

Gms Testing
John Gregory
256-323-7907

**DAVID EVANS
AND ASSOCIATES,**
2806 RUFNER RD, SUITE 200
BIRMINGHAM, AL 35210 (205)938-5555

| | |
|-------------|------------|
| REVISIONS | |
| PROJECT NO. | 9729.07 |
| FILENAME | 1SITEA0 |
| DATE | 08/31/99 |
| SHEET | OF A0.0 |